

Removal instructions

See step 3 of fitting instructions and cup respirator in hand to maintain position on face. Pull bottom strap overhead. Still holding respirator in position, pull top strap overhead and remove respirator. This respirator contains no components made from natural rubber latex.

NIOSH-approved: N95



Scandia Gear Europe BV

Lorentzweg 31 - 3208 LJ Spijkenisse, the Netherlands
TEL :+31 (0)181 600 955 FAX : +31 (0)181 600 966

THIS RESPIRATOR IS APPROVED ONLY IN THE FOLLOWING CONFIGURATION:

TC-	Protection ¹	Respirator	Cautions and Limitations ²
		SCANRESPI FFP2-V	
84A-7866	N95	X	ABCJMNOPS

1. Protection

N95 - Particulate Filter (95% filter efficiency level)
Effective against particulate aerosols free of oil;
time use restrictions may apply

2. Cautions and limitations

- A-Not for use in atmospheres containing less than 19,5 percent oxygen.
- B-Not for use in atmospheres immediately dangerous to life or health.
- C-Do not exceed maximum use concentrations established by regulatory standards.
- J-Failure to properly use and maintain this product could result in injury or death.
- M-All approved respirators shall be selected, fitted, used, and maintained in accordance with MSHA, OSHA and other applicable regulations.
- N-Never substitute, modify, add, or omit parts. Use only exact replacement parts in the configuration as specified by the manufacturer.
- O-Refer to User's Instructions and/or maintenance manuals for information on use and maintenance of these respirators.
- P-NIOSH does not evaluate respirators for use as surgical masks.
- S-Special or critical User's Instructions and/or specific use limitations apply. Refer to User's Instructions before donning.

***S Special or Critical User Instructions – The models SCANRESPI FFP2-V filtering face piece respirators were manufactured by Suzhou Fangtian Industries Co., Ltd for Scandia Gear Europe BV under TC-84A-7866.**

Scandia Gear Europe BV – Maritime Outfitters since 1974
Lorentzweg 31 - 3208 LJ Spijkenisse - The Netherlands

T +31 (0)181 600 955 E info@scandiegear.com
F +31 (0)181 600 966 I www.scandiegear.com

SCANRESPI FFP

HALF MASK RESPIRATOR

User's Manual



www.scandiegear.com



HALF MASK RESPIRATOR

This respirator helps protect against certain particles. **Misuse may result in sickness or death.** For proper use, see supervisor, instructions or contact us.

Important

Before use, the wearer must read and understand these user instructions. Keep insert for reference.

Use for

Solids such as those from processing minerals, coal, iron ore, flour and certain other substances. Liquid or non-oil based particles from sprays that do not also emit oil aerosols or vapours.

Do not use for

Paint spray, oil aerosols, gases, vapors, asbestos or sandblasting. This respirator does not supply oxygen.

Use instructions

- » Failure to follow all instructions and limitations concerning the use of the respirator and/or failure to wear the respirator for the whole duration of exposure to contaminants can seriously reduce the performance characteristics of the respirator and lead to illness, injury or death.
- » Before use, the wearer must first be trained by the employer in the correct use of the respirator in accordance with applicable safety and health standards.
- » OSHA standards including 29 CFR 1910.134(e) (5) and CSA standard Z94.4-93 require that the wearer be fit-tested. Before occupational use of this respirator a written respiratory protection program must be implemented meeting all the local government requirements. In the United States employers must comply with OSHA 29 CFR 1910.134 which includes medical evaluation, training, and fit testing.
- » Discard the respirator and replace with a new one if:
 - Excessive clogging of the respirator causes breathing difficulty.
 - The respirator becomes damaged.
- » Leave the contaminated area if dizziness, irritation or other distress occurs.

Use limitations

- » Do NOT use the respirator or enter or stay in a contaminated area under the following circumstances:
 - Atmosphere contains less than 19.5% oxygen
 - Atmosphere contains oil aerosols if using N protection class respirator
 - For protection against gases or vapors
 - Contaminants or their concentrations are unknown or immediately dangerous to life or health
 - Concentrations or contaminants exceed maximum use concentrations in applicable OSHA standards or applicable government regulations or 10 times the PEL (Permissible Exposure Limit), whichever is lower
 - For sandblasting, paint-spray operations, asbestos
- » Do NOT modify or misuse the respirator.
- » Do NOT use the respirator with beards or other facial hair that interferes with direct contact between the face and the edge of the respirator, or any other conditions that may prevent a good face-seal.

WARNING:

This respirator helps protect against certain contaminants. It may not eliminate the risk of contracting disease or infection. Misuse may result in sickness or death. Materials which may come into contact with the wearer's skin could cause allergic reactions to susceptible individuals.

FOR MORE INFORMATION or assistance please contact with Manufacturer.

Fitting instructions

Follow these instructions each time respirator is worn.

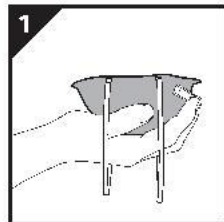

1. Hold the respirator in one hand with the nosepiece at your fingertips, allowing the headbands to hang below your hand.

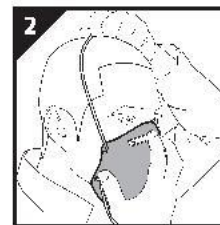

2. Press the respirator against your face with the nosepiece on the bridge of your nose.

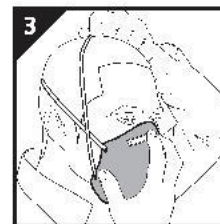

3. Place the top band high on the back of your head. Move the bottom band over your head and position it below your ears.

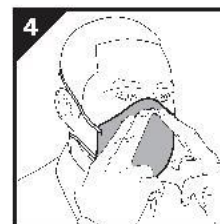

4. Using both hands, mould the nosepiece to the shape of your nose.



5. Test the fit. Cup both hands over the respirator and exhale vigorously. If air flows around your nose, tighten the nosepiece. If air leaks around the edges, reposition the bands for better fit.

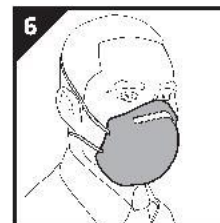

6. Fit-check the face-seal as follows:
 - Place both hands over the respirator without disturbing its position.
 - If the respirator is not fitted with an exhalation valve, exhale sharply.

- If the respirator is fitted with an exhalation valve, inhale sharply (a negative pressure should be felt inside the respirator).
- If you detect air-leaks, readjust the head straps and/or the position.